



Jay Flight SLX



Serial #: 1UJB0BL6M75Z0246
Model: 212QBW JAY FLIGHT SLX TT

Model Year: 2021 Dealer Name: BUTLER AUTO & RV CENT
142 TRANQUILLE ROAD
Kamloops, BC V2B 4G7
CAN

Standard Equipment

THE FOLLOWING ITEMS ARE STANDARD ON THIS MODEL
AT NO EXTRA CHARGE

- Exterior**
- Dexter® Axles with Nev-R-Adjust® brakes and E-Z Lube® hubs
 - I-class™ cambered structural steel I-beams
 - Fully integrated A-frame
 - Black tank flush
 - 5/8 in. tongue-and-groove plywood floor decking
 - Magnum Truss™ Roof System with plywood decking and seamless DiFlex II material
 - 2-sided reflective foil insulation in flush floor slideout floors
 - 13,500 BTU roof-mounted A/C
 - Galvanized steel, impact-resistant wheel wells
 - 30 amp service
 - 20 lb. propane bottles (2) with cover
 - Pullout camp kitchen (select models)
 - Large extended entry door handle
 - KeBloc exterior TV bracket
 - LED exterior lighting
 - Dark tinted safety-glass privacy windows
 - Large exterior downspouts (IN built units)
 - Rooftop solar prep
 - Spare tire with cover (IN built units)
 - Backup camera prep (IN built units)

- ROCKY MOUNTAIN EDITION (optional)**
- 8 cu. ft. refrigerator (ID built units)
 - 2nd fresh water tank – 80 gal. total capacity (ID built units)
 - Decorative slide room lighting (ID built units)
 - Deluxe colored metal (ID built units)
 - Porcelain foot flush toilet (ID built units)
 - Pullout kitchen faucet with sprayer (ID built units)
 - Sink cover and one rolling drying rack (ID built units)
 - Kitchen backsplash (ID built units)

- BAJA EDITION PACKAGE (optional)**
- 30 lb. propane bottles (2) (ID built units)
 - Flipped axle (ID built units)
 - 16 in. Goodyear® off-road tires (ID built units)
 - Triple step (ID built units)

- Interior**
- 81 in. ceiling height
 - Solid hardwood cabinet doors
 - LED interior lighting
 - Wardrobe/pantry storage
 - Large 50/50 acrylic kitchen sink
 - Brushed nickel faucets
 - Heavy-duty, 75lb., full extension, steel ball-bearing drawer guides
 - J-Steel™ jackknife sofa
 - Armstrong® vinyl flooring
 - Shaw® residential-grade carpet (select models)
 - Premium multimedia sound system with MP3/iPod input jacks and Bluetooth® connectivity
 - Digital TV antenna
 - Cable/satellite TV hookup
 - Residential height plywood bed platforms
 - Bedroom doors in place of curtains (select models)
 - Queen bed struts
 - Marine-grade toilet with foot flush
 - Tub surround
 - Bathroom exhaust vent
 - Shower curtain with curved shower track (select models)
 - Wood-trimmed mirror in bathroom
 - Queen Serta® mattress
 - Bedroom LED accent lighting
 - 300 lb. rated bunk beds (select models)
 - 600 lb. rated bunk beds (double bunks only)
 - Privacy curtains in bunk areas (select models)
 - 4 in. thick bunk mats (select models)
 - Smoke glass cabinet inserts (select models)
 - Seamless solid-surface look kitchen countertops (IN built units)

- CUSTOMER VALUE PACKAGE (MANDATORY)**
- Goodyear® Endurance® tires (made in the USA)
 - 6 gal. gas/electric DSI water heater
 - Bathroom skylight
 - Pleated window shades
 - Range hood
 - Water heater bypass
 - 3-burner range with glass cover
 - 6 cu. ft. Norcold® stainless steel refrigerator with temperature controls
 - Oven with glass door and interior light
 - Stainless steel microwave oven
 - Front diamond plate
 - Keyed Alike™ entry and baggage doors
 - Outside shower
 - Power awning with speakers and LED lights
 - Spare tire with cover
 - Stabilizer jacks (4)
 - JaySMART™ (Safety Markers And Reverse Travel) LED lighting (patent-pending)
 - Large folding entry door grab handle
 - Power tongue jack
 - Black tank flush (IN built units)

Optional Equipment

OPTIONAL EQUIPMENT INSTALLED ON
BY MANUFACTURER

- Base price
- Truffle
- CSA Standards
- Customer Value Package
- No Baja Edition
- Rocky Mountain Edition
- 13,500 BTU AC
- 24" TV
- Thermal Package with Enclosed Underbelly
- Aluminum Rims (14")
- Morryde Step Above Steps
- 30# LP Gas Bottles
- Roof Ladder
- Full Glue (Linoleum Requires Full Glue)

UNIT TOTAL

DEALER INSTALLED OPTIONS

Manufacturer's Suggested Retail Price

TOTAL AMOUNT DOES NOT INCLUDE STATE AND LOCAL TAXES OR LICENSE FEES. THE PRICE SHOWN ABOVE MAY OR MAY NOT BE REPRESENTATIVE OF THE ACTUAL SELLING PRICE OF SIMILAR RECREATIONAL VEHICLES IN YOUR AREA.

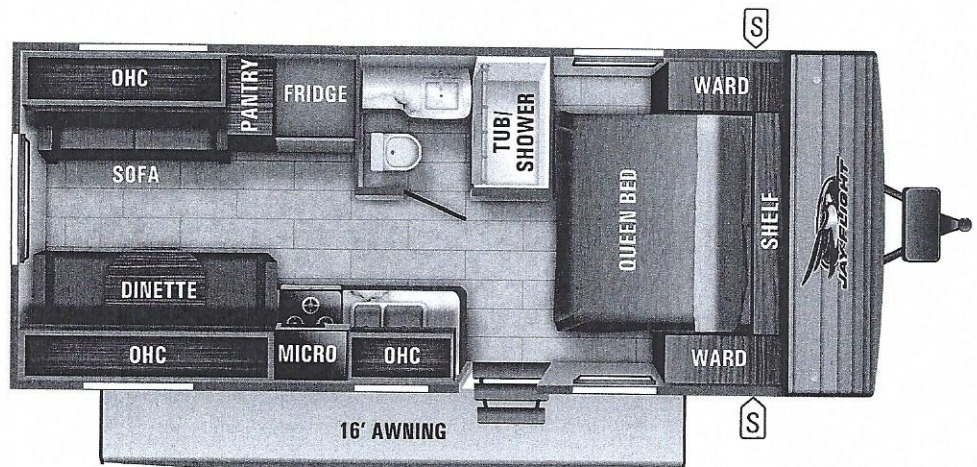

UVW

1996 kgs



Sleeps

4-5



Length

25' 8"

DIMENSIONS

Exterior height:.....131.75"

Exterior width:.....96.00"

WEIGHTS

GVWR:.....2721

GAWR (front):.....1587

GAWR (rear):.....1587

Approx. Gross Cargo Carrying

Capacity(GCCC):.....724

TIRES

Tire size (front):.....ST205/75R14D

Tire size (mid):.....

Tire size (rear):.....ST205/75R14D

Tire size (spare):.....ST205/75R14D

CAPACITIES

Fresh water tank (gals.):...80.00

Gray water tank (gals.):...39.00

Black water/toilet tank

(gals.):...39.00

Propane (kgs.):...27

Propane (gals.):...14

Water heater (gals.):...6.00

SEATING & SLEEPING

Queen bed:.....60 X 74

Sofa:.....42 X 60

Dinette:.....38 X 72

Some dimensions may be rounded and may vary from the actual dimensions

***Weights may be estimated calculations and may vary from the actual weight

- refer to the vehicle weight labels for actual weights***

Floorplans, features and specifications are subject to change without notice.

2+3
YEAR | YEAR
LIMITED | STRUCTURAL
WARRANTY